

CSF COMPUTER EXCHANGE 5 (CX5)



Facility Overview

CSF is expected to start the ground works for another Computer Exchange by 3rd Quarter of 2010. This facility will have 3 blocks of 5 storey data centres and a Class A office block incorporated with green building features. It will also be a carrier-neutral high end purpose built data centre.

Location	Cyberjaya, Malaysia
Gross floor area	Approximately 550,000 ft²
Net Data Center floor area	Approximately 200,000 ft²
Raised floor load	12.5kN/m² in data centre area 15kN/m² at M&E area
Raised floor	1m
Power density	30 W / ft² scalable up to 200 W / ft²
Power feed	Dual 33kV incoming sources Dual on premise 33kV Power Substation
Electrical services	High Tension & Low Voltage
Power back-up	Multiple back-up power generation
Uninterruptible Power Supply	N+1 or N+N option with 15 minutes battery reserve
Cooling system	Water-chilled and air-cooled systems
Fire suppression system	Water mist system in all data centre and common area. High Sensitivity Smoke Detection System Clean agent gas extinguishing system for the Power Substations.
Other	Data cabling and management Multiple Main Distribution Frame facilities Security access controls and intrusion alarms Water Detection System Dual Electrical Risers and Quadruple Data Risers

For further enquiries, please contact our Cyberjaya sales team:

E-mail : enquiry@csf-group.com

Tel : +(6) 03 – 8318 1313 Fax : +(6) 03 – 8318 0303

Ground Floor Plan Layout

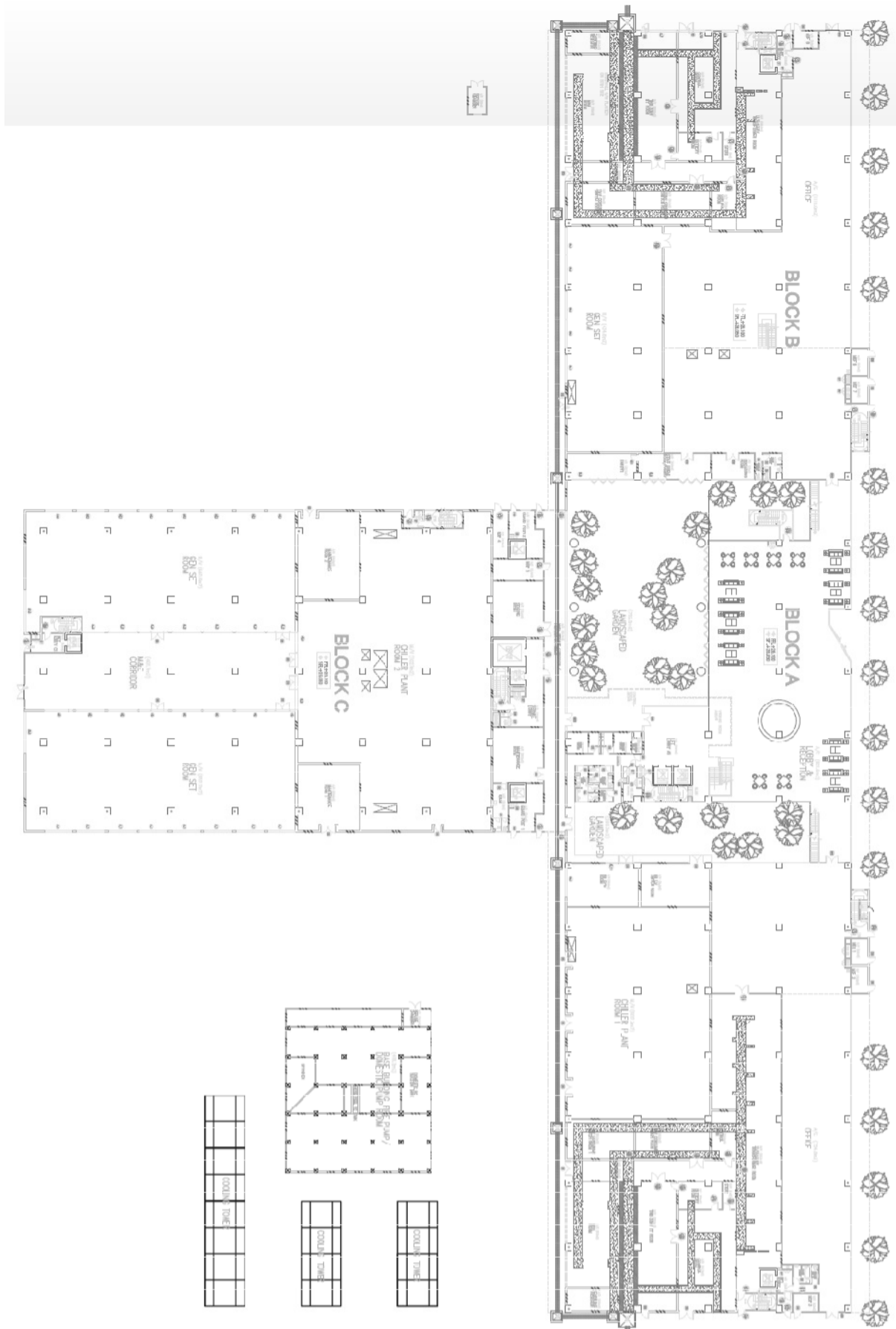

Typical Floor Plan Layout

